

## 800 Series

---

The MPL 800 series is a further extension on the 600 series featuring an all-aluminum-zinc alloy housing designed for heavy duty performance for more demanding, higher pressure applications from 10 PSI to 250 PSI.

---

### Summary

MPL 808 extends the range of MPL 600 style switches with snap action in an all-metal die-cast housing.

### Applications

- Medical Equipment
- Appliances
- Pneumatic Equipment
- Automation
- Industrial Monitoring & Control

### Features

- Customer Engineered Solutions
- High Pressure Capable
- Wide Temperature Operating Range
- Single Pole, Double Throw
- Snap Action
- NPT Fitting
- Historically Proven Reliability



# 800 Series

## Standard specifications

<b>Mechanical</b>	
Body	Zamak (aluminium-zinc alloy)
Base (options available)	Zamak (aluminium-zinc alloy)
Diaphragm (other options available)	Polyurethane
Burst pressure	500 PSI
Life	1,000,000 cycles
Weight	57 grams
Snap switch (other options available)	3 Amp 125, 250, 277 VAC 1/10 HP 250 VAC
Terminals (other options available)	Brass 0.187 x 0.20 male tabs
Contacts	Fine silver (0.1 and 1 amp switches use gold contacts)
Contact form	SPDT
<b>Functional</b>	
Operating position	Diaphragm horizontal
Operating temperature	-40°F to 185°F (-40°C to 85°C)

## Electrical

<b>Set point range</b>	<b>Tolerance</b>	<b>Hysteresis</b>	
10 to 180 PSI pressure (options available)	+/- 10%	up to 50%	
Adjustment locked	For specified set point		
Amperage	From 0.1A to 25A		
Voltage	125 VAC / 250 VAC		
Initial resistance	1 ohm max.		
<b>Agency</b>			
UL File #	E-12252		
CSA File #	LR41370		

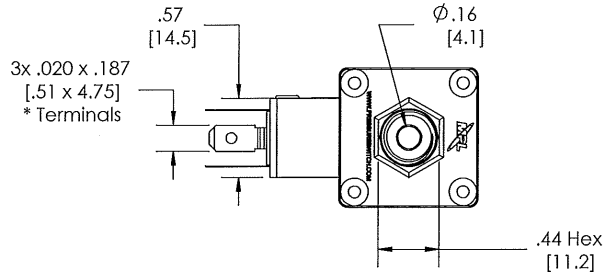
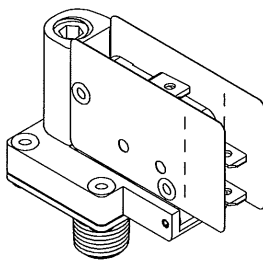
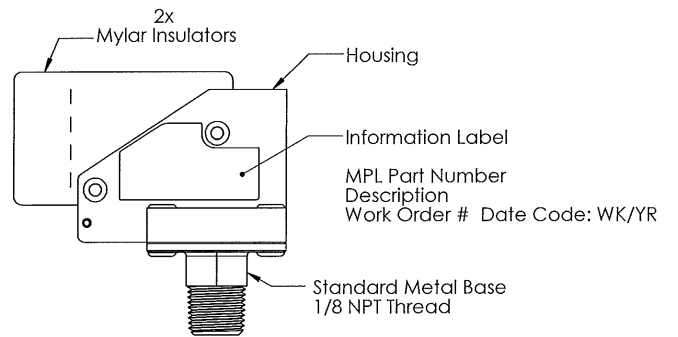
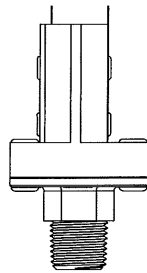
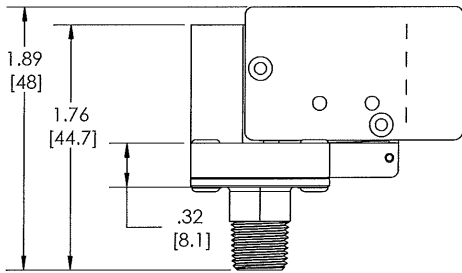
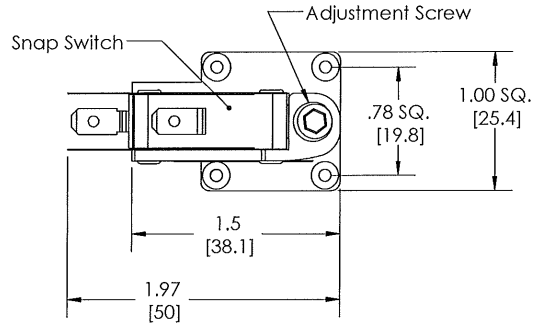
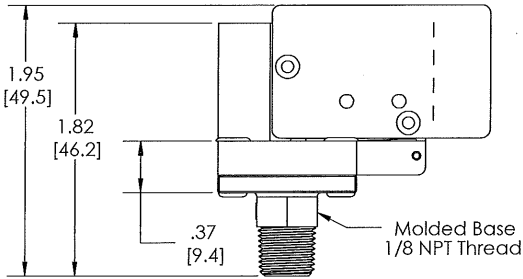



# 800 Series

## Ordering information

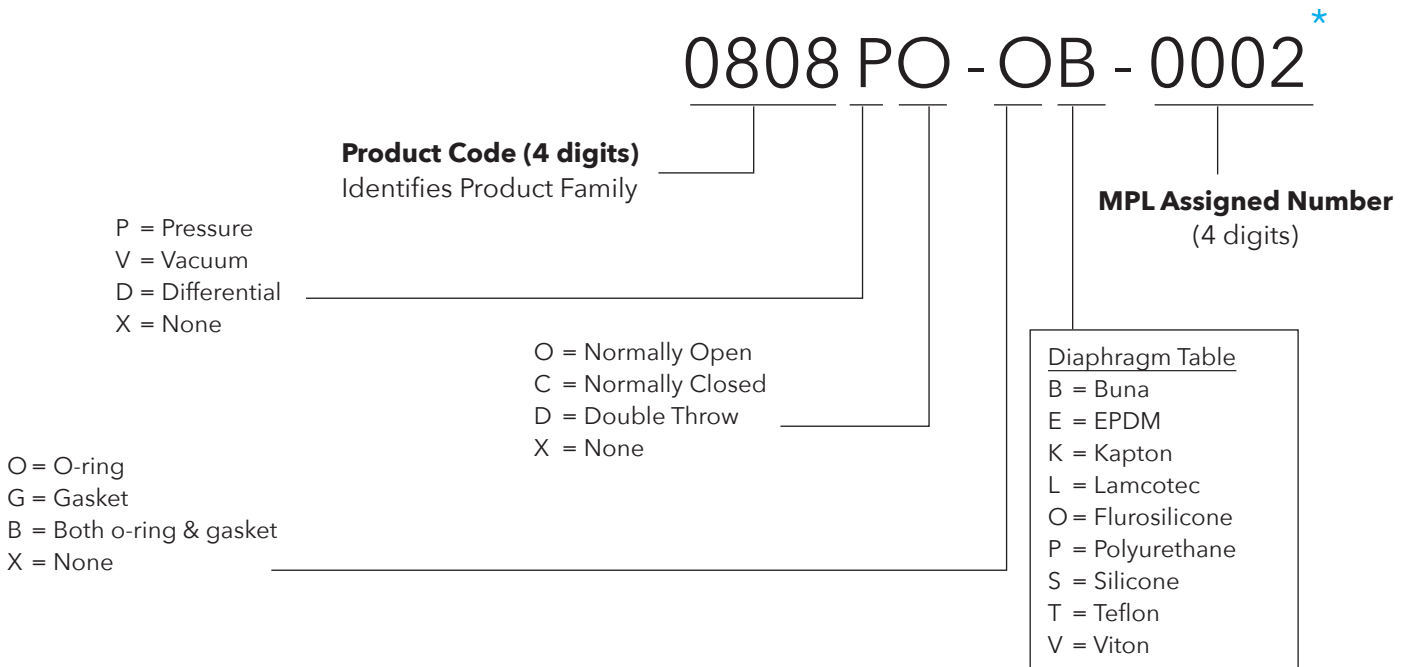

\* Call factory for MPL assigned number for pressure range and configuration.

## Ordering configuration

(Examples of the most popular models)

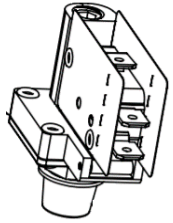
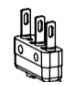
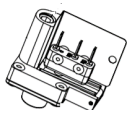
Part Number	Act	Deact	Proof	Current	Terminals	Form factor
0808PD-OL-0127	40.0 ± 8.0 PSI	"15 PSI (min)"	100 PSI	15 A	3 x 0.250" x 0.032"	
0808PO-OL-0129	6.0 ± 1.0 PSI	"3 PSI (min)"	200 PSI	25 A	2 x 0.250" x 0.032"	
0808PD-OK-0122	40.0 ± 4.0 PSI	-	150 PSI	15 A	3 x 0.250" x 0.032"	
0808PD-OK-0121	31.0 ± 3.0 PSI	-	180 PSI	1 A	 3 x sub mini	
0808PD-OK-0120	35.0 ± 3.0 PSI	"20 PSI (min)"	50 PSI	0.1 A	3 x 0.187" x 0.020"	